

Movelite Duo/ DuoXL Instructions and Care Manual

Thank you for purchasing an Outdoor Revolution product, this product will give years of satisfactory service if basic instructions are followed, our products are designed for durability and for ease of erection.

IMPORTANT: PLEASE CHECK YOUR EQUIPMENT

1 x Flysheet (or outer)

1 x Bag of steel pegs

1 x Adjustable roof pole

2 x Reflective Endurance Storm Straps

1 x Dual Action Hand Pump

Carrying Bag



****We highly recommend that you insure your awning against storm damage or accidental damage, as the warranty does not cover such eventualities. The manufacturer is not liable for any damage caused to the awning or its contents because of misuse, incorrect pitching or extreme weather****

Important information.

- ⇒ Please do not leave for your holiday without fully erecting and checking you have all the contents of your awning. If you are missing anything please contact your supplying dealer.
- ⇒ Please also note that manmade fabrics are prone to condensation when the warm air and moisture inside the awning comes into contact with the colder outside of the awning fabric. This is a perfectly natural occurrence and should not be confused with leaking. Ensure all Vortex Vents are open whenever possible to help combat condensation.
- ⇒ Ideally erect your awning for some period before use - allowing it to weather. 'Weathering' can take few uses of the awning before it is fully effective.
- ⇒ Make sure that before erecting, that you site the awning on clear level ground with no sharp objects underneath, and that all the zips are fully closed. (We recommend laying a groundsheet down to keep the awning dry and clean).
- ⇒ We suggest conducting a trial run of your awning to familiarise yourself with the set up and use of the awning. If you have any issues relating to pitching your awning please contact your dealer for help before going on holiday.
- ⇒ Please note this awning is designed as a 'touring' awning and not for permanent pitch.
- ⇒ After use always dry and air the awning before packing away to prevent damp.
- ⇒ Any dirt or stains can be removed by brushing or gently washing with warm water. DO NOT use detergents as this will destroy the waterproofing on the fabrics.
- ⇒ DO NOT cook or smoke in this awning; although the outer fabric is fire retardant treated it will still melt.
- ⇒ In the event of damage; use our contact form on our website www.outdoor-revolution.com and our customer service team will advise you as best as possible.

Optional Extras Available for the Movelite Duo/ Duo XL

- ⇒ Camping Carpet - cosy, soft carpet to fit on top of the groundsheet in your drive-away awning.
- ⇒ Double Inner Tent - clip in inner tent to fit inside the awning.
- ⇒ Trio Stripe Sleeping Bags - Available in different sizes, matching sleeping bags.
- ⇒ Selection of chairs and furniture.
- ⇒ Look at www.outdoor-revolution.com for more information.

Lifetime Guarantee

- ⇒ The Movelite AirFrame Tubes come with a lifetime guarantee*.
- ⇒ You must sign up for the Lifetime Guarantee on the Outdoor Revolution website for it to be valid.

Terms and Conditions apply - find the full terms and conditions on our website

PLEASE READ THE FOLLOWING ERECTION INSTRUCTIONS CAREFULLY.

TIP: Refer to the photograph to help when pitching your Movelite Duo /DuoXL

1. Spread the flysheet out on the ground of your pitch with the cowl side laying parallel to your vehicle.

2. Take the awning piping on the cowl and slide it through your awning channel until the awning is in the desired position on the vehicle. (If you are not attaching to a vehicle skip this step).

3. Peg down the four corners of the awning to hold it down whilst you inflate it.

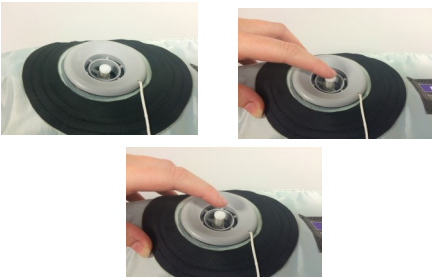

4. Before inflating any of the AirFrame Tubes make sure the Dynamic Speed Valve quick release buttons are pressed out. This makes sure the air will be held inside the AirFrame tube.



5. Next, attach the pump to the first of the two Dynamic Speed Valves and begin to carefully inflate - taking care that no part of the fabric is caught anywhere.



6. Inflate the AirFrame until you can give it a good squeeze. The tube wants to have room inside for air to expand. Don't worry if you do keep inflating - the Intelligent Frame will release any excess air. (Please note the Intelligent Frame is set to 5.5psi).



7. Repeat steps five and six with the second AirFrame Tube. Then place the caps back in the valves and cover with the Velcro sleeve to keep the awning looking neat and tidy.



8. Then peg out and tension the front of the awning. Use the adjustable pegging straps to tension the awning as you desire. Make sure you don't over tension the fabric. If a door is taut it may be too tight and that could cause damage.



11. Peg out all the remaining pegging points and guy lines starting from the corner against the vehicle and work round the awning.



12. Peg out the Reflective Endurance Storm Straps for extra stability. Please make sure in heavier weather you use all the guy lines and storm straps to hold the awning in place.

13. Finally, slot the adjustable steel pole in to the black pockets in the roof of the awning. Adjust to tighten the roof.

Visit the website for Video Instructions

Warning: Never unzip the zips on the protective sleeves whilst the AirFrame Tubes are inflated. This may result in the tube bursting or ballooning out of the sleeve - causing damage to the tube and the sleeve.

Packing away your awning.

- ⇒ Zip up all the windows and doors before deflating.
- ⇒ Unpeg the guy lines, storm straps and most of the pegs around the awning - leaving the four corners pegged out.
- ⇒ Open each of the Dynamic Speed Valves in turn and press in the quick release button. Leave the button pressed in.
- ⇒ Unpeg the four corners and pull the awning out of the awning channel.
- ⇒ Lay the awning flat on the ground.



- ⇒ Fold the awning lengthways to make a long thin straight line.



- ⇒ Measure the width of the bag up against the width of the folded awning to make sure the awning is going to fit.



- ⇒ Begin to roll the awning as tight as possible from the opposite end of the Valves to expel all the air as you roll.

- ⇒ Place the rolled awning on to the bag and pull the sides up round it. Finally, Zip up the bag.



Trouble-Shooting.

<u>Problem</u>	<u>Reason</u>	<u>Solution</u>
The Air Tube keeps deflating after removing the pump.	The Dynamic Speed Valve quick release button hasn't been pressed back out.	Press the quick release button back out to shut the valve.
The awning is leaking.	Usually 'leaking' is actually condensation which forms on the inside of the product.	Open all the Vortex Vents in the awning to help increase air circulation and help reduce condensation.

In the event of a puncture.

- ⇒ If you have a small puncture in your Air Frame Tube you can easily repair it using a standard puncture repair kit.
- ⇒ To remove the Air Frame Tube - deflate the tube and then unzip the two protective sleeves over the tube and pull the Air Tube out. Do not unzip the sleeves whilst the tube is inflated.
- ⇒ Locate the puncture repair the puncture on the Air Frame Bladder.
- ⇒ Place the Air Tube back in to the sleeves in the correct place with the valves in the valve hole. Make sure the Tube is straight and not twisted.
- ⇒ Zip the two sleeves back up fully.
- ⇒ Inflate the AirFrame Tube again, ensuring that the puncture has now been repaired.
- ⇒ If this process doesn't work you may have to buy a new bladder.

****Spare AirFrame Bladders can be bought to replace damaged ones.**
Visit the Spares Section at www.outdoor-revolution.com or contact us on 01924 455313**

****Awnings will not be replaced because of damaged bladders****



Outdoor Revolution Awnings are distributed by:
Outdoor Revolution Ltd
www.outdoor-revolution.com